

# THE LEGAL WORKPLACE 2023

TRENDS | INSIGHTS | CASE STUDIES



INSPIRING  
WORKSPACE  
FURNISHINGS

**HAWORTH**  
A Best in Class Dealer

## WHAT LAWYERS WANT

In 2022, 2000 American Bar Association members who were working in jobs that required a law degree responded to a Practice Forward Survey. Their advice for space and people leaders was to...

- Create a culture that supports **Hybrid Work**
- Create a culture that addresses **Wellness & Mental Health**
- Create a culture that encourages and fosters **Diversity, Equity, and Inclusion**
- Create a culture that maximizes the use of **Technology**

**Does your workplace enable this kind of culture?**



A modern office interior featuring a light-colored wooden desk with a grey ergonomic chair. In the background, there is a black metal shelving unit with various decorative items, including books, a yellow circular object, and a white bust. To the right, there are two red armchairs. The floor is covered with a patterned rug. The overall lighting is warm and professional.

# 96%

**OF FIRMS ARE IMPLEMENTING  
RETURN-TO-OFFICE POLICIES  
ON A FIRMWIDE BASIS WITH 41%  
MANDATING ATTENDANCE.**

*Savills Am Law 100 Return-To-Office Survey  
Jan 2023*

## KEY INSIGHT

### LEGAL WORKSPACES ARE BECOMING MORE SOCIAL

"We're creating these workplace hubs; lot of firms have a workplace café. But we're creating these workplace areas where you can meet or be in the company of others, and trying to amp up that ability to collide, and for young people to build their networks. I think I've seen a new interest in law firm clients to make sure that's an important component of their projects, especially post-COVID. The leaders I talk to are very interested in having that space,"

~ Timothy Bromiley

Principal, Studio Director, Gensler

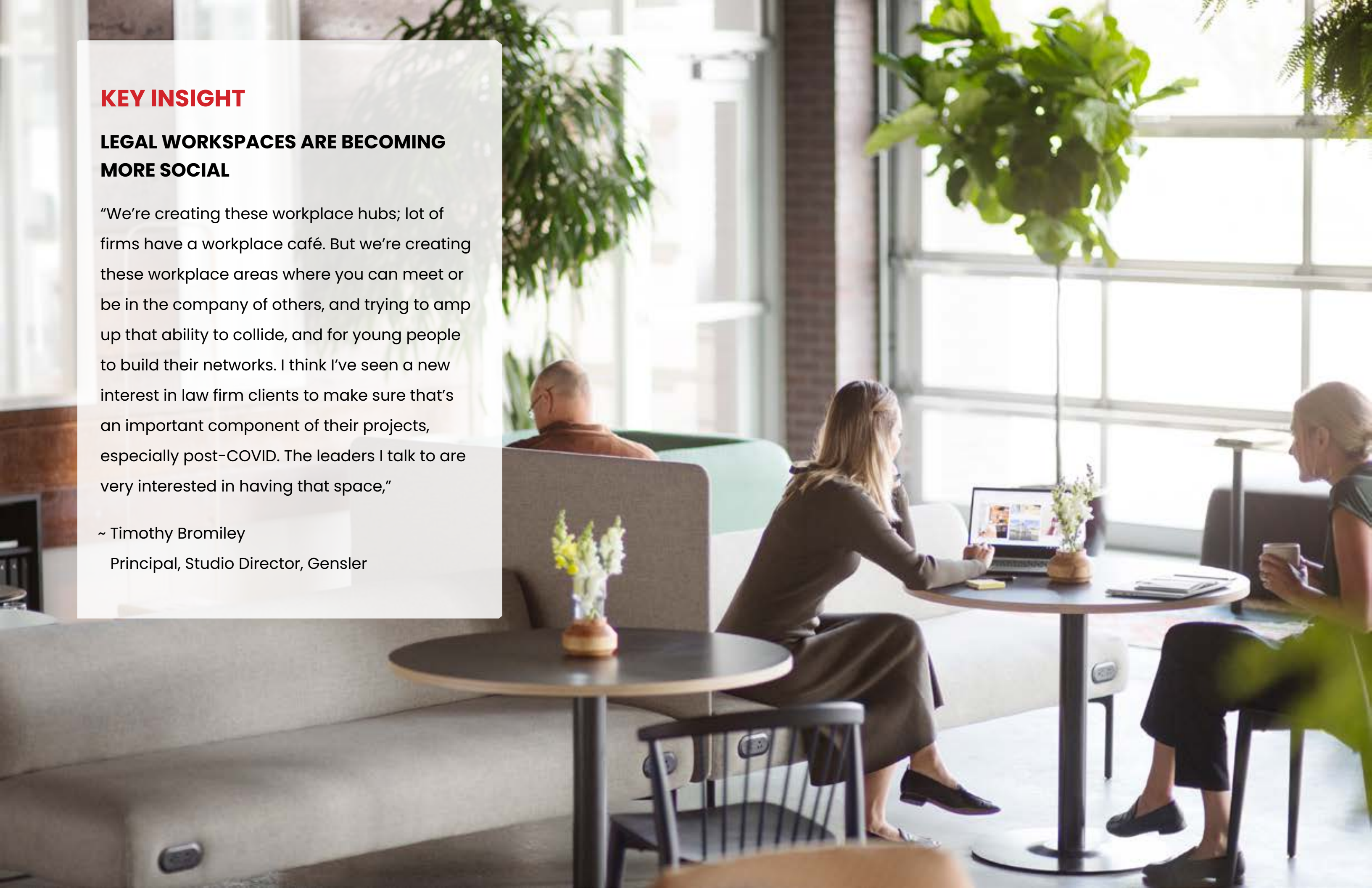



## A COMMUTE-WORTHY EXPERIENCE

Realizing that mandates can be bad for culture (and retention), many firms are determined to earn the commute and create an in-office experience with benefits that outweigh those of remote work in the eyes of partners and staff.

- **Location** - Class A trophy buildings in prime locations with easy access to public transportation are highly sought after. Live-Work-Play developments are becoming popular.
- **Workspace** - High-end hospitality feel, robust amenity spaces, increased collaboration spaces and unassigned, flexible spaces that support hybrid work and team-based task.
- **Technology** - Accelerated integration of workplace technology such as video conferencing, sensors, smart buildings and cloud-based tools.
- **Incentives** - From free meals and gym memberships to increased pay, better access to leadership and sophisticated amenities.

## TOP RTO DRIVER: PEOPLE

Leadership in almost every industry is looking for ways to encourage teams back into the office. According to over 20,000 professionals and trillions of Microsoft 365 productivity signals analyzed by Microsoft...

- 85% of employees would be motivated to go into the office to **rebuild team bonds**
- 84% of employees would be motivated to go into the office to **socialize with co-workers**
- 74% of employees would go to the office more frequently if their **“work friends”** were there
- 73% of employees would go to the office more frequently if they knew their **direct team members** would be there

*\* Thomson Reuters' 2023 State of the Legal Market Report*





## KEY INSIGHT

### **COMPETITIVE DIFFERENTIATION THROUGH TECHNOLOGY IS TOP 2023 PRIORITY FOR LAW FIRMS**

73% of law firm professionals report that they intend to increase the technology usage to become more competitive in 2023.

*IPRO 2023 State of Law Firm Industry Report*

## KEY INSIGHT

### Artificial Intelligence Can Not Yet Replace Legal Professionals

“Lawyers exercise independent professional judgment. AI cannot currently emulate essential lawyer skills such as strategic and creative thinking, conflict resolution, negotiation, emotional intelligence and empathy. In short, the things that make a good lawyer great.”

~ Katherine Muldoon, Muldoon & Partners

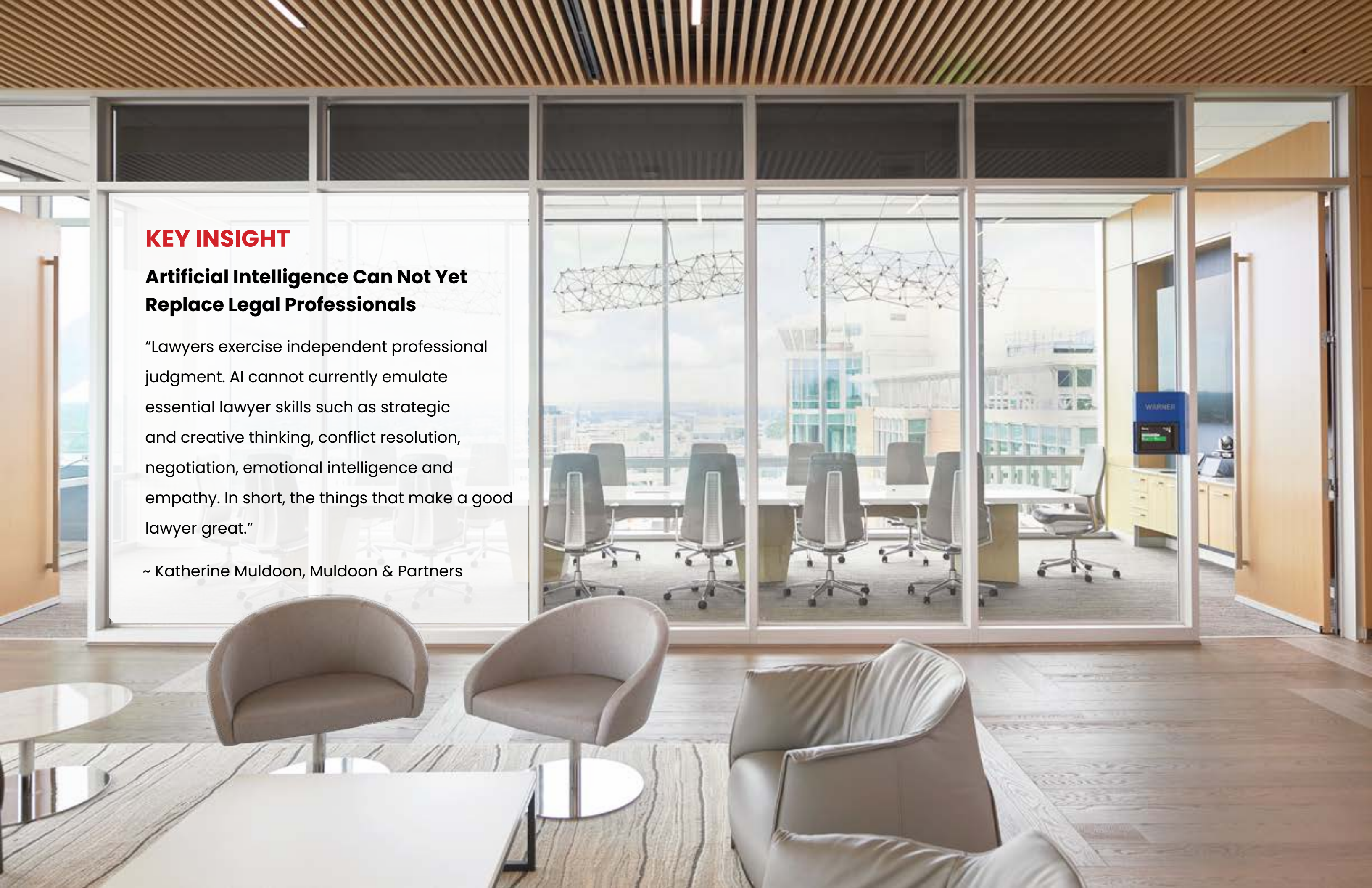



# CASE STUDIES

# Confidential Law Firm

Valued Client Since 2017

BOS partnered with a law firm to create a workspace encompassing ancillary furniture and Partner offices over 7 floors in Chicago's premier new construction high-rise on the Chicago River.

The scope included lounges on each floor and full amenity floor for reception, conference, training and dining with a variety of imported European designer furniture.

The client is a global law firm with lawyers located in more than 40 countries throughout the Americas, Europe, the Middle East, Africa and Asia Pacific, strategically positioned to help their clients with legal needs. Typical clientele range from multinational, Global 1000, and Fortune 500 enterprises to emerging companies developing industry-leading technologies.

## PRIMARY MANUFACTURER

Halcon offices & conference tables, Wilkhahn seating

## KEY PARTNERS

Hines, DRI, Gensler, Clune Construction

## SQUARE FOOTAGE

200,000

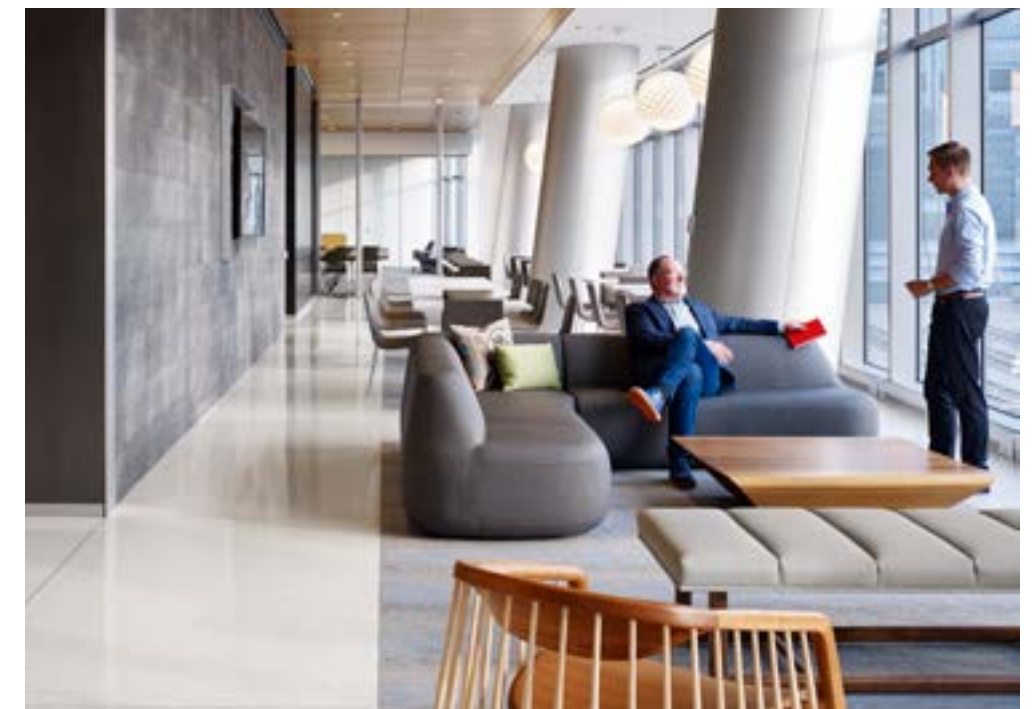

# Husch Blackwell

Valued Client Since 2019

From the outset, Husch Blackwell worked with all members of the project team to ensure both planning and design reflected the firm's values of inclusion, transparency, teamwork, and creativity.

By engaging everyone – from the furniture dealer/manufacturer to the engineers – early in the process, each group was able to work in a cohesive manner that allowed them to create unique solutions that achieved the overall project goals.

**SQUARE FOOTAGE**

36,000

**NUMBER OF EMPLOYEES**

99

**PRIMARY MANUFACTURER**

Haworth

**LOCATIONS**

Across the United States



**VIEW MORE PHOTOS**

[www.bos.com/showcase/husch-blackwell](http://www.bos.com/showcase/husch-blackwell)



akerman

# Akerman

---

BOS partnered with Akerman LLP to expand their downtown Dallas office into an entire new floor in the Trammel Crow Center. The new space reflects a contemporary, professional aesthetic with 43 paralegal and attorney offices, 12 admin stations, 5 formal conference rooms, a cafe and a collaborative space with Haworth's Workware technology.

Akerman LLP is a leading transactions and trial law firm known for its core strengths in middle market M&A, within the financial services and real estate industries, and for a diverse Latin America practice. With more than 650 lawyers and government affairs professionals and a network of 24 offices,

*"It's been our pleasure to work with the BOS team; from planning stage to installation - they gave their 100%. Their attention to detail and their willingness to go 'above and beyond' attitude has been outstanding at every turn of our projects. Keep up the outstanding job BOS. We at Akerman truly appreciate it."*

---

#### PRIMARY MANUFACTURER

Haworth, Davis, Datesweiser, Allseating, HBF, Allermuir, Keilhauer, Martin Brattrud, Cumberland

#### KEY PARTNERS

Design Firm: Staffelbach,  
Installation Company: The Spencer Company

#### SQUARE FOOTAGE

27,277





INSPIRING  
WORKSPACES  
FOR OVER 75 YEARS

# IN HOUSE. IN CONTROL.

## QUICK STATS

- Celebrating over 75 years in business
- Haworth's 1st dealer partner
- Consistently in Haworth's top 10-15 dealers since 1948
- Consistently in AIS's top 1-3 dealers since 2005
- Receives Haworth's rare "Best in Class" distinction each year

## SOLID FINANCIALS

BOS is financially sound and consistently profitable, with offices in Illinois, Wisconsin and Florida.

## 360° SERVICES

Design, project management, decommissioning, installation: BOS is capable of doing everything in-house to minimize risk & maximize opportunity.

## SPECIALIZED TEAMS

To maximize every aspect of your move and your space, we are proud to offer specialized expertise, including in-house union installation, walls, digital marketing agency and technology integration.

## 100% EMPLOYEE OWNED

BOS is proud to be ESOP 100% employee-owned, so every employee has a vested interest in performing at the highest levels.



**INSPIRING  
WORKSPACE  
FURNISHINGS**



BOSworkspaces



BOS\_workspaces



BOSworkspaces



BOSworkspaces

**CONNECT WITH US**

[www.BOS.com](http://www.BOS.com)  
877.267.0267  
[info@bos.com](mailto:info@bos.com)

**HEADQUARTERS**

501 South Gary Avenue  
Roselle, IL 60172  
877.267.0267

**CHICAGO**

325 N Wells St STE 110,  
Chicago, IL 60654  
312.670.8530

**ORLANDO**

200 Technology Park  
Lake Mary, FL 32746  
407.805.9911

**TAMPA**

1600 E Eighth Ave. C-201  
Tampa, FL 33605  
813.549.7310